

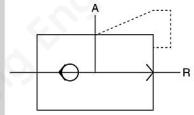

KKP-08



How to Order?

Series No.	Port Size	Thread Type
KKP: Quick exhaust valve	06: 1/8" 10: 3/8" 08: 1/4" 15: 1/2"	Blank: G P: PT T: NPT

Order Example:

KKP quick exhaust valve. 1/4" port size, G thread, ERP code is: KKP-08

Product Features

* Normally, it isn't used in pneumatic system separately, always used with main valve together, offering a good assistance for main valve to control the whole system, so the system can work very well.

Specifications

Model	KKP-06	KKP-08	KKP-10	KKP-15
Working medium	Clean air (After 40 μm filtration)			
Working pressure (MPa)	0.15-0.8			
Guaranteed. pressure resistance (MPa)	1.2			
Working temperature (°C)	-5-60			
Port size	1/8 - 1/2			

Main Dimension

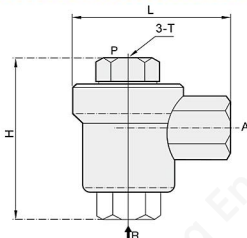

Model	T	H	L
KKP-6	G1/8	37	41.5
KKP-8	G1/4	45.5	38
KKP-10	G3/8	56	46.5
KKP-15	G1/2	67	54