



ISO Model aluminium alloy pneumatic cylinder

1. Standard sizes in stock.
2. Wider range of models allow selection of the ideal cylinder for almost any application.
3. Flotating cushion design against shake while starting.
4. Reed switches can be applied.
5. Aluminum alloy barrel against rust.

Specifications

Series	AQ	AQR
Action	Standard	Double acting type
Bore	ø32,ø40,ø50,ø63,ø80,ø100,ø125	
Operating fluid	Air	
Proof pressure	1.5MPa {15kgf/cm ² }	
Operating pressure	0.07~0.97MPa {0.7~9.9kgf/cm ² }	
Piston speed range	50~500mm/sec	
Temperature range	-10°C~+70°C (Not freezing)	
cushion	With adj. cushion at both ends	
Lubrication	Not required	

How to order

AQ	R	40	X	50	LB	SH	2
Series	With magnet	Bore		Stroke	Mounting type	Reed switch	Switch quantity
AQ Standard type 		ø32 ø40 ø50 ø63 ø80 ø100 ø125		25~1000mm	LB Foot mounting 	SH-22 	1:1PC 2:2PCS
AQW Double rod 					TC Trunnion 	Bracket 	
					FA/FB Front/ Rear Flange 	● For other sensor, please refer to 4 series.	
					CA Single clevis 		
					CB Double clevis 		
					CBB Rearhinge mounting 		

Standard stroke

Stroke \ Bore	25	50	75	100	125	150	175	200	250	300	350	400	450	500	550	600	650	700	750	800	850	900	950	1000
ø32	●	●	●	●	●	●	●	●	●	●	●	●	●	●	●	●	●	●	●	●	●	●	●	●
ø40	●	●	●	●	●	●	●	●	●	●	●	●	●	●	●	●	●	●	●	●	●	●	●	●
ø50	●	●	●	●	●	●	●	●	●	●	●	●	●	●	●	●	●	●	●	●	●	●	●	●
ø63	●	●	●	●	●	●	●	●	●	●	●	●	●	●	●	●	●	●	●	●	●	●	●	●
ø80	●	●	●	●	●	●	●	●	●	●	●	●	●	●	●	●	●	●	●	●	●	●	●	●
ø100	●	●	●	●	●	●	●	●	●	●	●	●	●	●	●	●	●	●	●	●	●	●	●	●
ø125	●	●	●	●	●	●	●	●	●	●	●	●	●	●	●	●	●	●	●	●	●	●	●	●

● Non-standard strokes are available upon request.

Internal construction

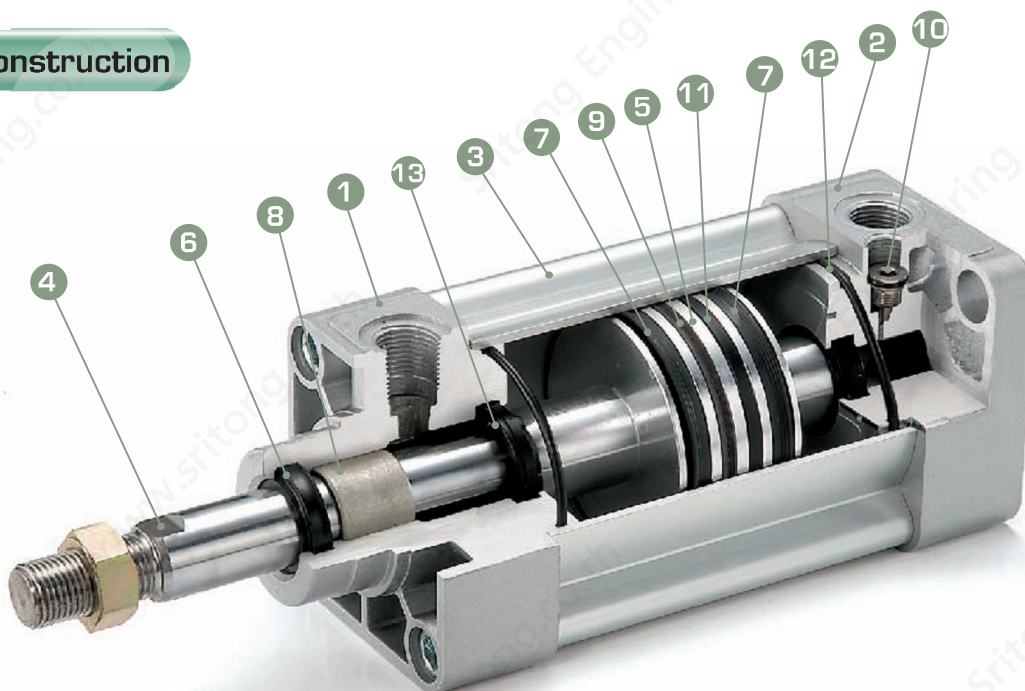

Part lists

NO	Description	Material	Qty
1	Front end cover	Aluminium alloy	1
2	Rear end cover	Aluminium alloy	1
3	Barrel	Anodized aluminium alloy	1
4	Piston	Hard chrome plated carbon steel	1
5	Piston	Aluminium alloy	1
6	Piston rod seal	NBR	1
7	Piston seal	NBR	2
8	Bush	Oil filled, sintered bronze	1
9	Magnet	Resinous magnet	1
10	Cushion screw	Carbon steel	2
11	Wear ring	POM	1

Seal lists

Description \ Bore	6 Piston rod seal	7 Piston seal	12 End cover seal	13 Cushion ring
ø32	DRP12	APP32	SM28	PDF16
ø40	DRP16	AGP40	SM36	PDF20
ø50	DRP20	AGP50	SM46	PDF25
ø63	DRP20	AGP63	AS140	PDF25
ø80	DRP25	AGP80	SM75	PDF30
ø100	DRP25	AGP100	G95	PDF30
ø125	DRP35	USH125	G120	PDF50

External Dimensions

Standard type

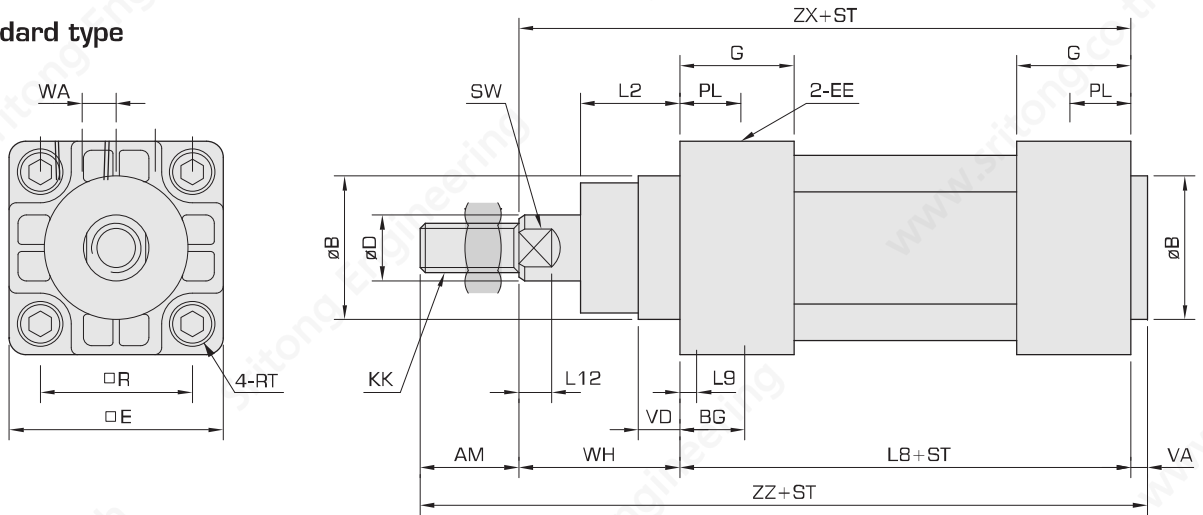

Bore	AM	ϕB	BG	ϕD	E	EE	G	KK	L2	L8	L9	L12	PL	R	RT	SW	VA	VD	WA	WH	ZX	ZZ
$\phi 32$	22	30	15	12	47	G1/8"	26	M10X1.25	16	94	6	6.5	10	32.5	M6	10	4	7	4	26	120	146
$\phi 40$	24	35	15	16	53	G1/4"	30	M12X1.25	20	105	6	8	15	38	M6	14	5	9	4	30	135	164
$\phi 50$	32	40	18	20	65	G1/4"	30	M16X1.5	25	106	6	8	15	46.5	M8	17	5	11	4	37	143	180
$\phi 63$	32	45	18	20	75	G3/8"	32	M16X1.5	25	121	6	8	16	56.5	M8	17	5	13	7	37	158	195
$\phi 80$	40	45	22	25	95	G3/8"	38	M20X1.5	32	128	6	10	19	72	M10	22	6	15	7	46	174	220
$\phi 100$	40	55	22	25	115	G1/2"	40	M20X1.5	35	138	6	10	20	89	M10	22	6	15	7	51	189	235
$\phi 125$	54	60	22	35	140	G1/2"	40	M27X2.0	40	160	6	15	16	110	M12	32	8	-	-	65	225	281

Double rod end (standard type) AQW X

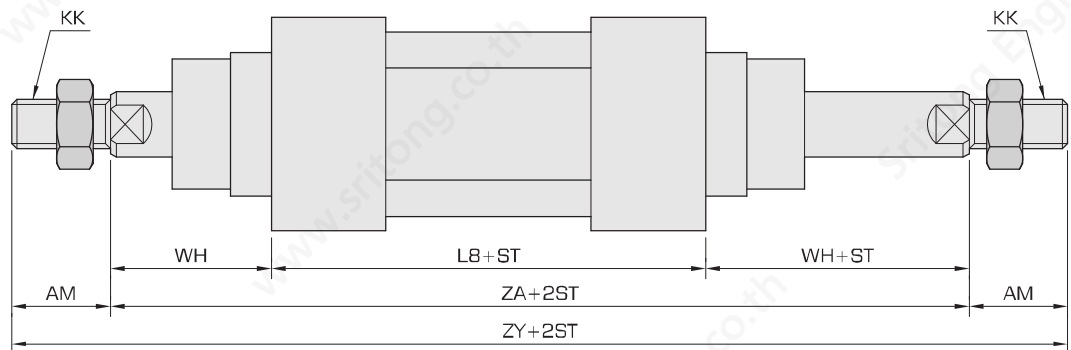

Bore	AM	KK	L8	WH	ZA	ZY
$\phi 32$	22	M10X1.25	94	26	146	190
$\phi 40$	24	M12X1.25	105	30	165	213
$\phi 50$	32	M16X1.5	106	37	180	244
$\phi 63$	32	M16X1.5	121	37	195	259
$\phi 80$	40	M20X1.5	128	46	220	300
$\phi 100$	40	M20X1.5	138	51	240	320
$\phi 125$	48	M27X2.0	160	65	290	386

External Dimensions

Rear flange (FB)

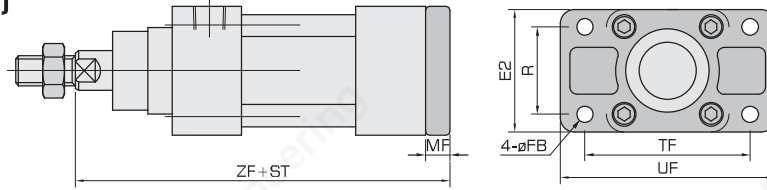

Bore	E2	FB	MF	R	TF	UF	ZF
ø32	50	7	10	32	64	79	130
ø40	55	9	10	36	72	90	145
ø50	65	9	12	45	90	110	155
ø63	75	9	12	50	100	120	170
ø80	95	12	16	63	126	153	190
ø100	115	14	16	75	150	178	205
ø125	140	16	20	90	180	220	245

Single clevis (CA)

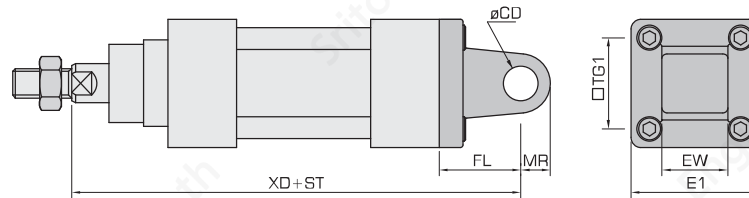

Bore	øCD	□E1	EW	FL	MR	□TG1	XD
ø32	10	47	26	22	10.5	32.5	142
ø40	12	53	28	25	13	38	160
ø50	12	65	32	27	13	46.5	170
ø63	16	75	40	32	17	56.5	190
ø80	16	95	50	36	17	72	210
ø100	20	115	60	41	21	89	230
ø125	25	140	70	50	25	110	275

Double clevis (CB)

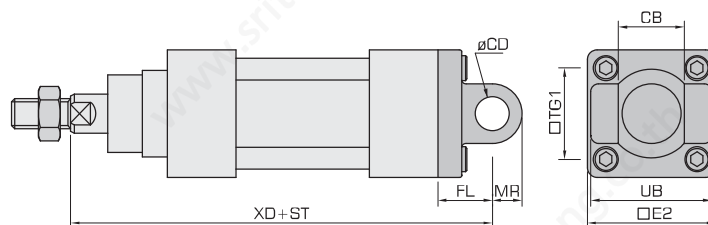

Bore	CB	øCD	□E2	FL	MR	□TG1	UB	XD
ø32	26	10	47	22	10.5	32.5	45	142
ø40	28	12	53	25	13	38	52	160
ø50	32	12	65	27	13	46.5	60	170
ø63	40	16	75	32	16	56.5	70	190
ø80	50	16	95	36	17	72	90	210
ø100	60	20	115	41	21	89	110	230
ø125	70	25	140	50	25	110	130	275

External Dimensions

● Trunnion (TC)

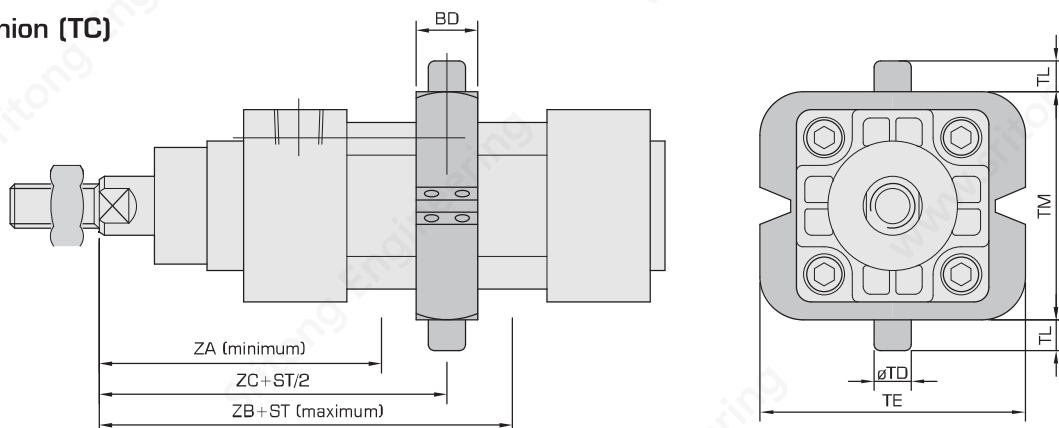

Bore	BD	TD	TE	TL	TM	ZA	ZB	ZC
ø32	22	12	58	12	50	73	73	73
ø40	28	16	70	16	63	77	77	82.5
ø50	32	16	85	16	75	86	86	90
ø63	35	20	100	20	90	89.5	89.5	97.5
ø80	40	20	120	20	110	107	107	110
ø100	45	25	145	25	132	116.5	116.5	120

● Male trunnion (CBB)

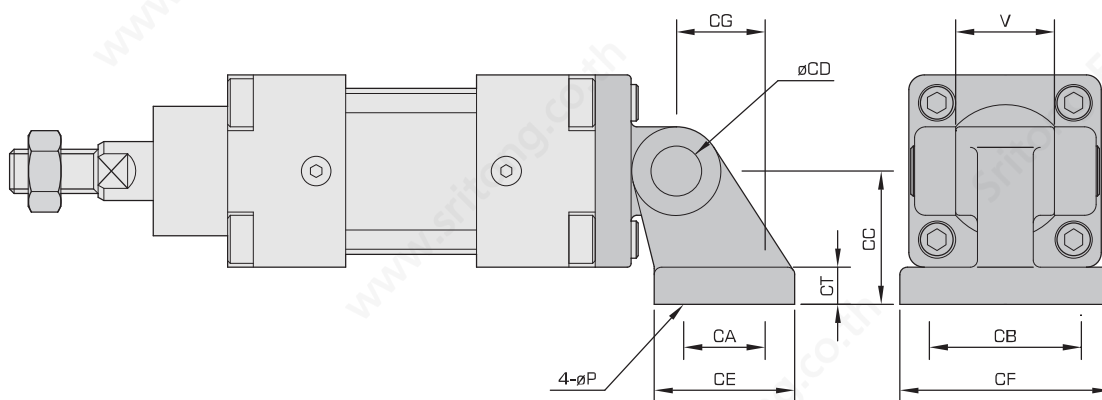

Bore	CA	CB	CC	øCD	CE	CF	CG	CT	V	øP
ø32	18	38	32	10	32	54	21	8	26	ø7 thru hole, ø11 c'bore, dp5
ø40	22	41	36	12	38	57	24	10	28	ø7 thru hole, ø11 c'bore, dp5
ø50	30	50	45	12	50	70	33	12	32	ø9 thru hole, ø14 c'bore, dp6
ø63	35	52	50	16	55	72	37	12	40	ø9 thru hole, ø14 c'bore, dp6
ø80	40	66	63	16	64	90	47	14	50	ø11 thru hole, ø18 c'bore, dp8
ø100	50	76	71	20	74	100	55	16	60	ø11 thru hole, ø18 c'bore, dp8
ø125	60	94	90	25	90	124	70	20	70	ø11 thru hole, ø18 c'bore, dp8